

Large Hexagons Installation Guide

1 VISUALIZE YOUR LINES & DRY LAYOUT

Start by unpacking all your tile and doing a dry layout. This allows you to see the variation and move the tile around to create a balanced look. While placing the tiles next to each other, think of the Hexagons as a grid, making sure the points line up, along with the grout lines. (This is true whether you are doing a “points up” or “flat side up” orientation)

POINTS UP



FLAT SIDE UP

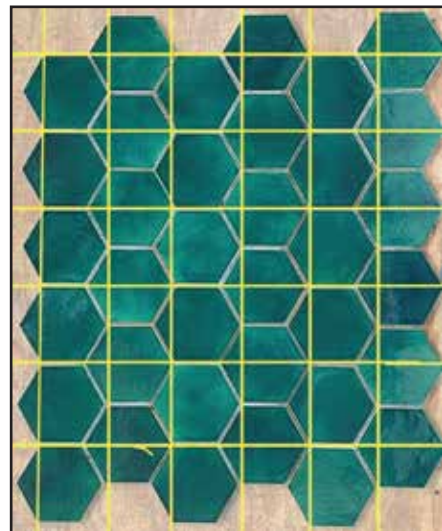

2 MEASURE FROM POINT TO POINT

Use a measuring tape to make sure that you have even alignment. Measure from point to point, keeping the distances consistent. (Keep in mind that handmade tile has size variation, so it may not be totally perfect, but should be within a 1/8” range)

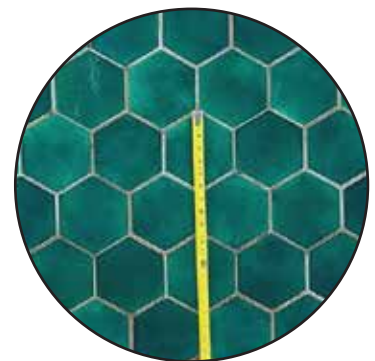
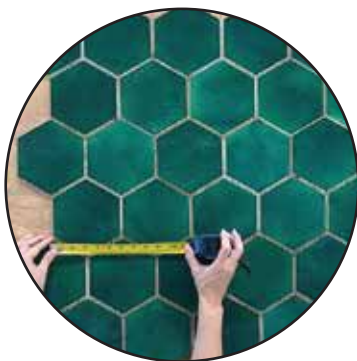

Large Hexagons Installation Guide

3 CHECK THE GROUT SPACE

You may also notice that some of tiles will have tighter grout spacing. If you have meshed sheets, you can cut the mesh with a box cutter or scissors (or just pull the tile off the mesh) to release that tile and readjust to even out the grout spacing.

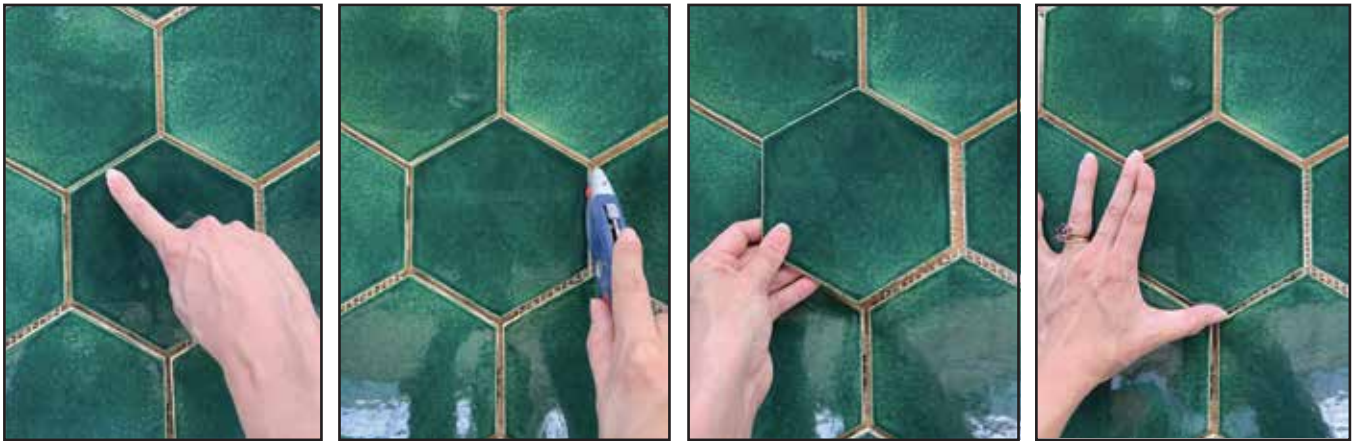

4 INSTALL

Once you have examined your dry layout and are satisfied with the grout spacing and color variation you are ready to install!

★ TIPS

- If you are installing on a wall, we recommend using a level to ensure that your horizontal lines are even, along with using a tape measure.
- When cutting tile in corners, use the other side of the tile that you cut off to continue the pattern onto the adjacent wall.
- Always seal the tile BEFORE grouting to ensure the grout doesn't stain the tile. It also makes it much easier to clean the grout.
- Reseal your tile every 1-3 years. You can determine if you need to reseal by conducting a water drop test: simply splash some water onto your tile and if it beads off, it is fully sealed. If the water absorbs into the tile, it is time to reseal. (We recommend Aqua Mix Sealer's Choice Gold for all your sealing needs.)